

MONZONE®

COMPLETE AND CUSTOMISED SOLUTION
FOR YOUR TRANSPORT REFRIGERATION NEEDS



TAILORED TO YOUR TRANSPORT REQUIREMENT



monzonegroup.com



monzonegroup.com.my

INTROD



▪ About Us

1-2



▪ Trucks, Insulated Container
▪ Trailers

3-4



▪ Manufacturing Process
▪ Quality Assurance & Control

5



▪ Customised Container

7-8



▪ Containers & Build

9-12



▪ Moveable Partition,
Manual Flip & Bulkhead

13

SCAN & EXPLORE MONZONE



MONZONE
WEBSITE



MONZONE
FACEBOOK



MONZONE
INSTAGRAM

GET TO KNOW US &

UNCTION



- Innovation Cold Chain Solutions **14-16**



- Power Tail Lift
- EV Truck **17-20**



- Eutectic Plate System
- Eutectic Insulated Container **21-22**



- Monzone Track Record
- Customised Project & Tenders **23-26**



- Machinery Overview **27-28**

SCAN TO CONNECT



MONZONE
LINKEDIN



MONZONE
TIKTOK



MONZONE
YOUTUBE

About Us

Caring Services, Optimising Cost & Solution For Success

Founded in 1997, Monzone has become a trusted leader in Southeast Asia, specializing in transport refrigeration systems and the manufacturing of insulated containers of various standards.

As an official distributor of globally recognized cold chain solutions, we serve clients across Malaysia, Singapore, the Philippines, and Thailand. Our advanced systems are engineered to meet stringent Good Distribution Practice (GDP) standards, ensuring the safe, reliable, and compliant transport of pharmaceutical products.

Guided by the visionary leadership of our founder and Managing Director, Mr. Teoh, Monzone has built a high-performing, cohesive workforce driven by a strong spirit of collaboration and excellence.

Our sales team is certified to manage pharmaceutical cold chain products and undergoes annual specialist skills certification to ensure compliance with industry standards. We remain committed to delivering sustainable, cost-effective cold chain transport solutions tailored to our clients' evolving needs.

Monzone Group excels in optimizing cost and efficiency in the transport cold chain industry by manufacturing various grades of insulated containers tailored to different market segments. Our clients include transport refrigeration of perishable food, beverage, wine, and seafood distributors, cold chain logistics companies, in-flight catering providers, and pharmaceutical businesses.

Corporate Philosophy

OUR VISION



To be the most Successful and Respected Transport Refrigeration System and Insulated Container Manufacturer in South East Asia.

OUR MISSION



Every Cold-Chain Business will have a MONZONE-THERMO KING, your Strategic Business Partner that attract and attain you with High Value Products, Customized Solutions and Caring Services.

OUR QUALITY POLICY



We are all driven by a common commitment to serve the need of our customer better than anyone else, continuously improve on our level of product Quality and Services.

ENVIRONMENT POLICY



We are committed to protecting the environment by conserving resources, minimizing waste, and preventing pollution in all our operations.

HEALTH & SAFETY POLICY



We prioritize health and safety above all. All incidents, including near misses, must be reported and investigated to prevent recurrence. We are committed to consultation and participation of workers in all aspects of health and safety.

Our 5 Core Values



Quality



Integrity



Continuity



Innovation



Improvement

Our Team

- Sales & Marketing Group
- Aftersales; Customer Service Team
- Product Engineers
- Engineering Drawing Team
- Project & Tender Group
- Quality Assurance & Quality Control
- Skilled Production Head, Supervisors & Trained Workers
- Planner, Internal Auditor, Operation Director, HR, Finance

Our Strength

- Competent in providing a comprehensive Cold Chain Transport Solutions to your needs.
- Able to handle projects, tenders and customer stringent requirements.
- Able to optimise your operation cost through quick response in service, repair, maintenance and prolong product lifespan.
- We stock commonly used parts and components to support our customers operations thereby reducing downtime and increase productivity and work efficiency.



Our Achievements

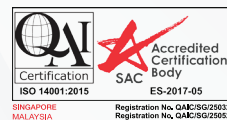

PVC STRIPS CURTAIN RIBBED
Antibacterial Activity and Efficacy Testing
Test Report No.: 168578198a 001

**FRP (GLASS FIBER REINFORCED
POLYESTER COMPOSITE PANELS)**
Antibacterial Activity and Efficacy Testing
Test Report No.: 168585881a 001



Trucks and Insulated Container

Monzone manufactures a comprehensive range of insulated containers in-house, leveraging nearly 30 years of expertise in constructing refrigerated truck bodies. Our skilled craftsmen use only the finest components and high-quality materials to ensure exceptional performance and reliability.

Our range includes both low and high back insulated bodies, ideal for food service deliveries. Each container is constructed using premium-grade FRP (Fiberglass Reinforced Panels), meeting stringent safety and health standards. Additionally, we incorporate GRP (Glass Reinforced Panels) for enhanced strength, durability, and resistance to corrosion, moisture, and chemicals—ensuring long-lasting performance in even the most demanding delivery environments.



Trailers

Monzone's specially designed refrigerated trailers have been serving the transport industry for nearly 30 years, setting the benchmark for quality and reliability. Supported by a team of highly qualified refrigeration and vehicle mechanics, our customers' fleets is regularly maintained to ensure compliance, optimal performance, and dependable service tailored to meet diverse customer requirements.



Manufacturing Process

At Monzone, every insulated container is built with pride, and every vehicle that bears our badge stands as a testament to our unwavering commitment to craftsmanship. This passion drives everything we do. With nearly 30 years of experience in manufacturing refrigerated trucks, our expertise is reflected in every vehicle meticulously hand-crafted by our skilled team. Whether we're expanding our own extensive national hire fleet or building a fully customized Signature Series truck for a valued client, you can trust that each unit is 'Built with Pride' by the Monzone team—delivering the highest standards of quality, performance, and reliability to support your business.

DEFINING QUALITY.
DELIVERING RELIABILITY.



Quality Assurance & Control

In manufacturing, Quality Assurance (QA) and Quality Control (QC) are critical components that ensure product integrity, reliability, and compliance with industry standards.

At Monzone Manufacturing, we are committed to implementing systematic processes, procedures, and standards across the entire production cycle to proactively prevent defects and ensure consistent product quality. This approach encompasses thorough planning, supplier assessments, precise equipment calibration, and comprehensive staff training.

Quality Control complements this by focusing on the inspection, testing, and verification of in-process components, individual parts, and final products to identify and address any non-conformities before delivery. These activities are carried out by our experienced quality engineers and technical inspectors.

In adherence to ISO 9001 standards, our integrated Quality Assurance and Quality Control practices form a robust quality management system that enables us to consistently deliver high-performance, defect-free products that meet or exceed customer expectations.

Customised Container

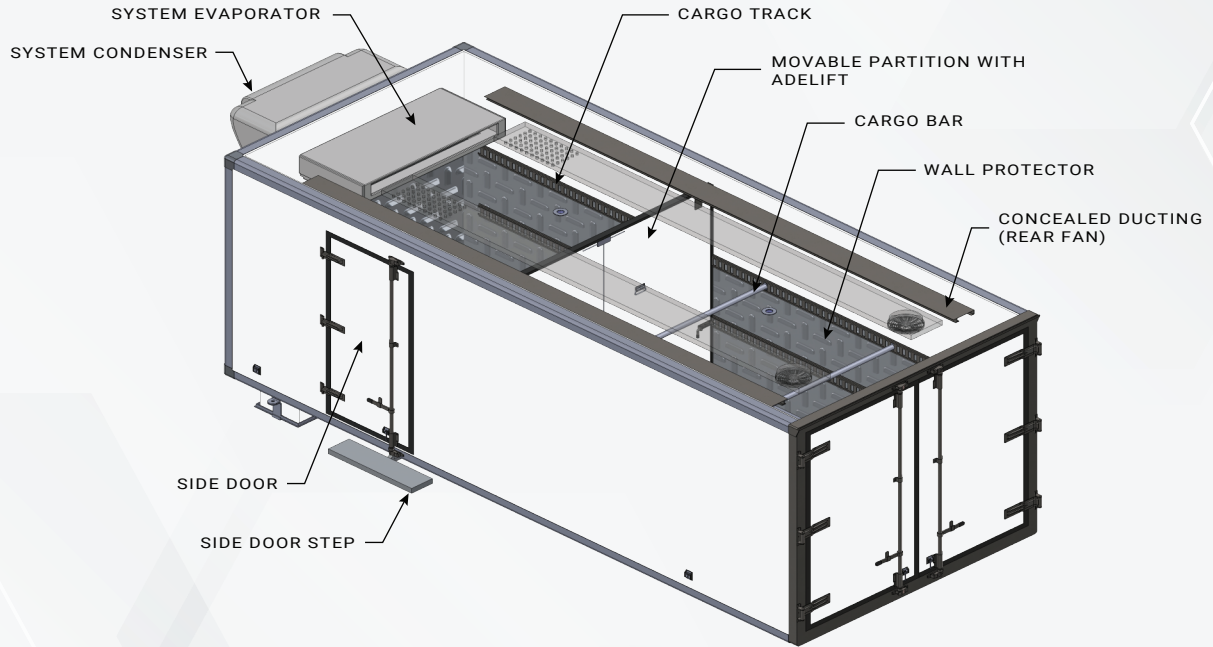

✓ Monzone refrigerated truck One-piece panels. More constant K Values (Thermal Conductivity)

✓ Quickly assembled with simple tools such as screws, glue, and screw guns.

✓ More efficient compared with traditional welding technology, which can save labor and time costs.

✓ Completion of the Monzone refrigerated truck is anticipated within approximately THREE weeks

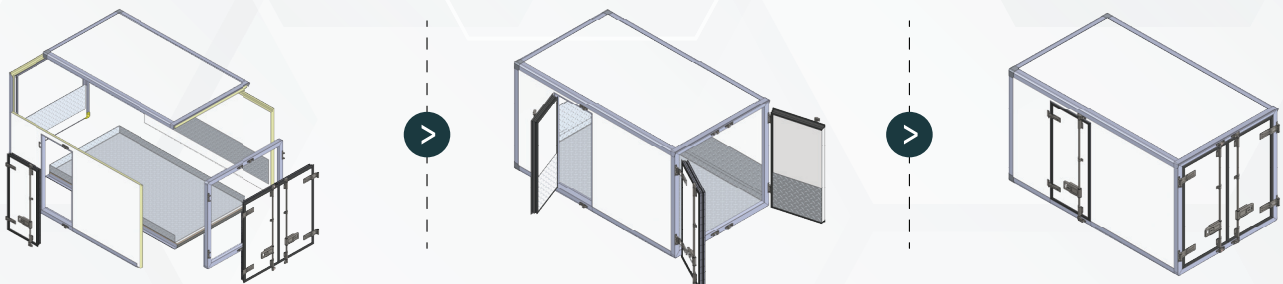

Assembly Process

STEP 01

BOX CHASSIS MOUNTED TO FLOORING

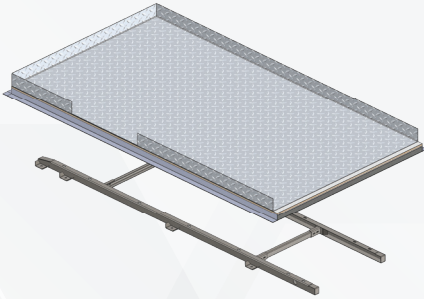

STEP 02

PANEL ASSEMBLY

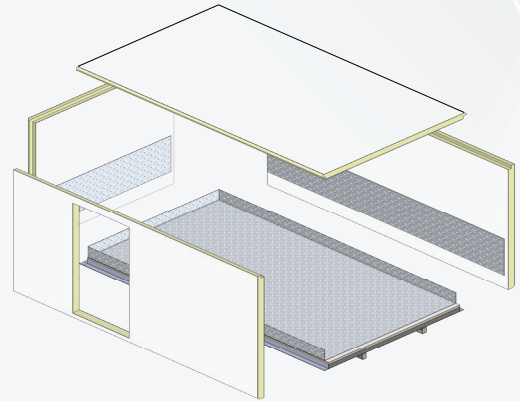

STEP 04

DOORS & ACCESSORIES ASSEMBLY

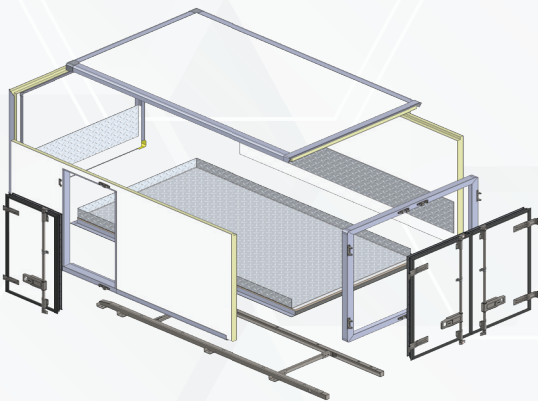

STEP 03

PROFILES & FRAMES ASSEMBLY

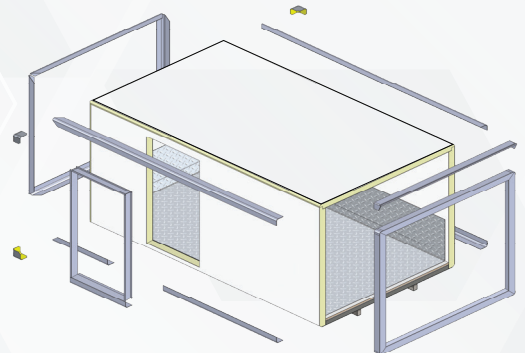

Side Panels

- Lightweight foaming glue
- 4-7 layers of continuous fiberglass
- High compression-resistant insulation material
- Continuous fiberglass material frame, which is waterproof and corrosion-resistant

Structure

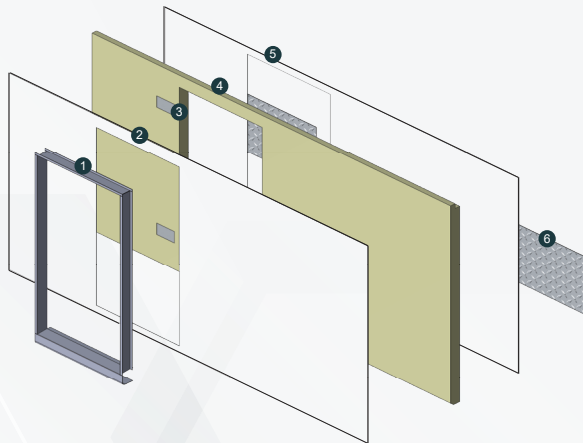

1. **Side door frame** (High-Strength stainless steel)
2. **Outer Skin** (FRP/GRP External)
3. **Aluminium Plate** (For Hinges)
4. **Core Material** (PU Foam)
5. **Inner Skin** (FRP/GRP Internal)
6. **Side Wall Protector** (Stainless Steel, Checker Plate)

Containers & Build - External Features

The primary options for insulated boxes are extruded polystyrene (XPS) or polyurethane (PU) sandwich panels with FRP (Fiber-Reinforced Plastic) skins. These can be categorized into mirror-level FRP or common FRP. Additionally, we can provide various types of internal reinforcements for the panels to meet the diverse needs of our customers.

Outer Skin	FRP Color Standard: White Weight: Can be customised UV resistant, Applicable in food & medical transportation	
	XPS (Extruded Polystyrene)	Density: 40kg/m ³
Core Material	PU (Polyurethane)	Density: 40kg/m ³
	FRP Color Standard: White Weight: Can be customised UV resistant, Applicable in food & medical transportation	

Length	Width	Thickness
Max: 45ft	≥ 3000mm	XPS: 17~150mm
		PU: 25~150mm

Properties	Polyurethane (PU)	Extruded Polystyrene (XPS)
Material	Thermosetting	Thermoplastic
Thermal Conductivity	20.3 mW/mk 0.0203 W/mk @ 10°C	29 mW/mk 0.029 W/mk @ 25°C
Water Absorption	3% ISO 2896 EN 12087 ASTM D2842	0.4% GB/T 8810-2005
Dimension Stability	0.5~1% EN 1604/ ASTM D2126	≤1.4% GB/T8811
Density	40kg/m ³	40kg/m ³

Optional:

High Impact Glass Reinforced Panel (GRP), combines the strengths of several construction materials, metals, thermoplastics and duopolistic.

- High impact strength at low weight
- Superior tensile and flexural strength and e-moduli
- Excellent UV and weathering stability
- No splintering caused by over stress

Panel Options



FRP



GRP



XPS



PU

Self-Supporting Structural Floor

- Patented subframe design, adaptable to different Chassis
- Lightweight, high-strength floor
- No thermal or cold bridge, reduce heat transfer and improve insulation
- Steel or aluminium circulation floor, or aluminium channel floor

Structure

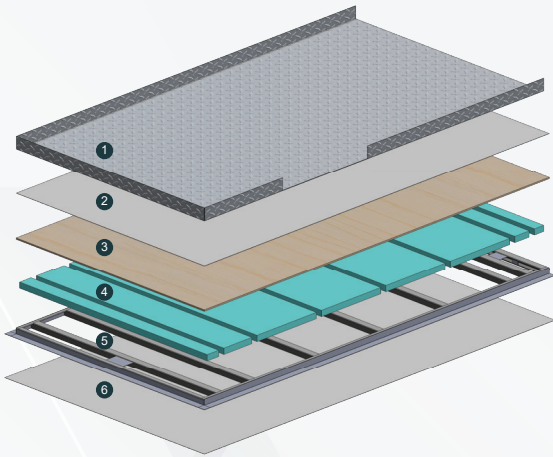

1. **Flooring Protector** (Stainless Steel, Checker Plate)
2. **Inner Skin** (FRP/GRP Internal)
3. **Lightweight, High-strength layer** (Marine Plywood)
4. **Core Material** (PU Foam)
5. **Frame Structure** (Lightweight, high-strength, Waterproof)
6. **Outer Skin** (FRP/GRP External)

Floor Options

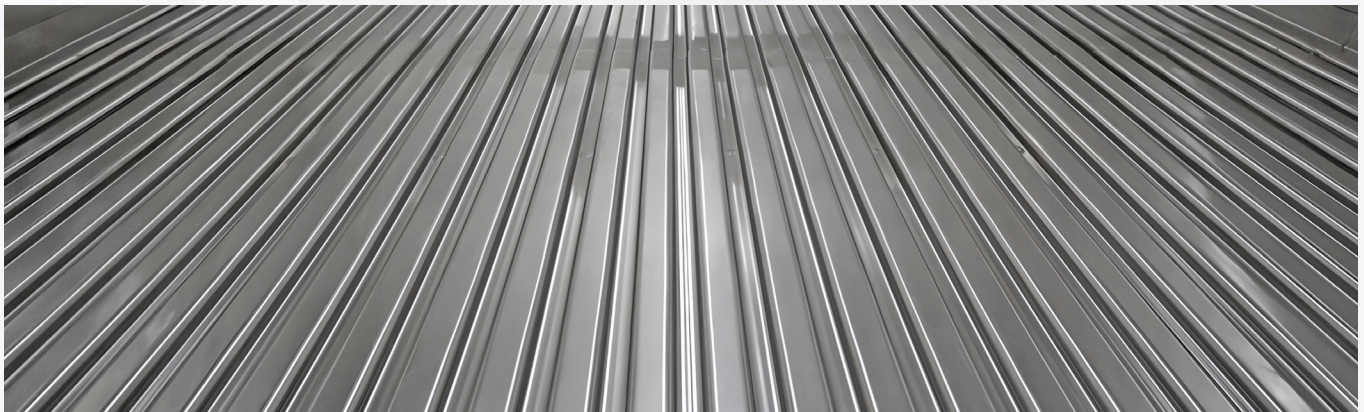

Stainless Steel Corrugated Panel

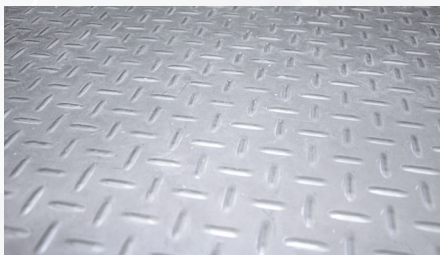

Stainless Steel Checker Plate Embossed

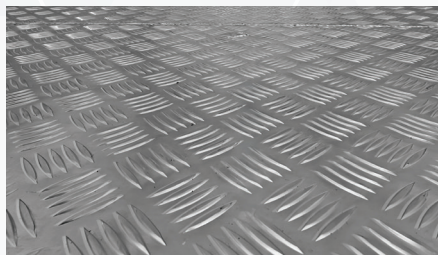

Aluminium Checker Plate Panel



Stainless Steel Checker Plate Solid

Side Door Panel

- Patented subframe design, adaptable to different chassis
- Lightweight, high-strength floor
- No thermal or cold bridges, reduces heat transfer and improve insulation
- Steel or aluminium circulation floor, or aluminium channel floor

Structure

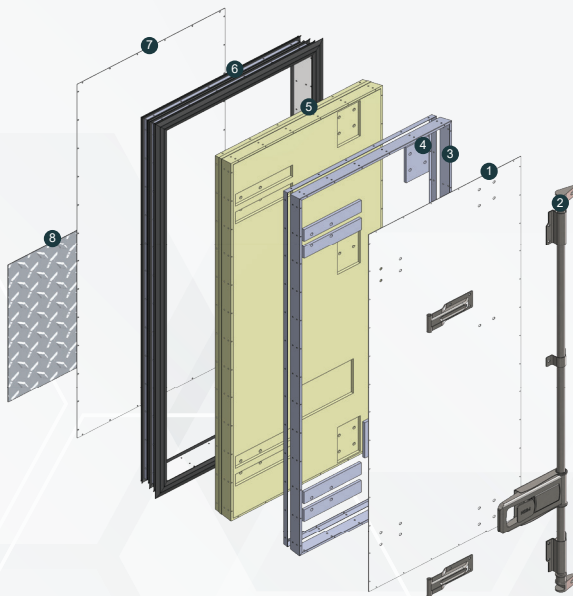

1. **Outer Skin** (FRP/GRP External)
2. **External Lock Set**
3. **Frame** (Lightweight, high-strength, Waterproof)
4. **Metal Plate Embedded**
5. **Core Material** (PU Foam)
6. **Gasket**
7. **Inner Skin** (FRP/GRP Internal)
8. **Side Door Protector**

Side Door Panel and Door Handle Set



Side Door with
Cargo Lock Handle



Side Door with
Embedded Handle



Butterfly Side Door with
External Lock Handle Set

Rear Door Panel

- Patented subframe design, adaptable to different chassis
- Lightweight, high-strength floor
- No thermal or cold bridge, reduce heat transfer and improve insulation
- Steel or aluminium circulation floor, or aluminium channel floor

Structure

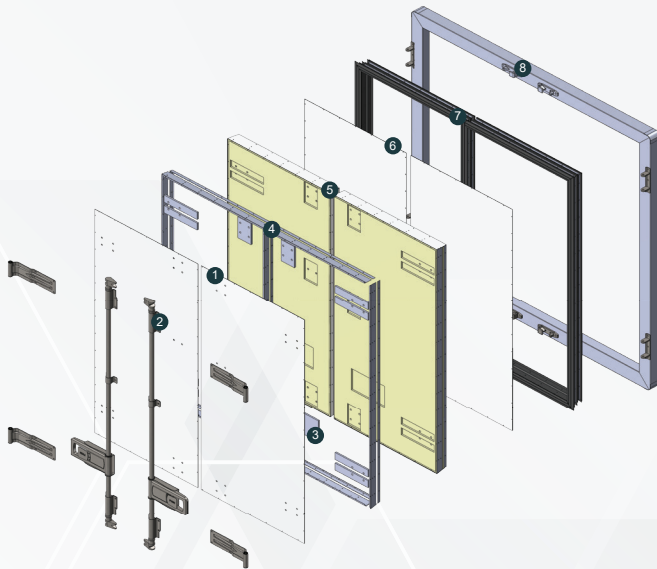

1. **Outer Skin (FRP/GRP External)**
2. **Hidden Lock Set**
3. **Metal Plate Embedded**
4. **Frame (Lightweight, high-strength, Waterproof)**
5. **Core Material (PU Foam)**
6. **Inner Skin (FRP/GRP Internal)**
7. **Gasket**
8. **Rear Door Frame**

Rear Door Panel



Butterfly Back Door with Cargo Lock Handle Set



Butterfly Back Door with Duo External Lock Sets



Internal Door Handle



Side Door Hinges



External Door Handle



Rear Door Hinges

Moveable Partition, Manual Flip & Bulkhead

The moveable partition enables multi-temperature zones for flexible compartment configurations, while the manual flip allows quick adjustments for optimised delivery. The bulkhead ensures effective temperature separation and airflow, preserving perishable goods. Designed for durability and versatility, it meets diverse delivery needs efficiently.



Moveable Partition

Scan for more information:



Manual Flip



Bulkhead

Scan for more information:

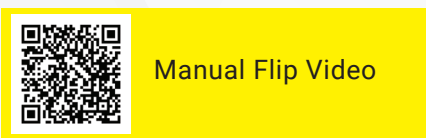

Scan for more information:

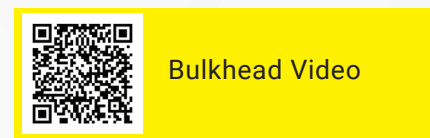

Innovative Cold Chain Solutions

Cargo Bar

A spring-loaded cargo bar secures cargo in trucks and trailers by creating tension between walls, preventing shifts during transit.



Cargo Bar

Cargo Track

A cargo track is a metal rail system in trucks and trailers for securing loads with straps, bars, or tie-downs.

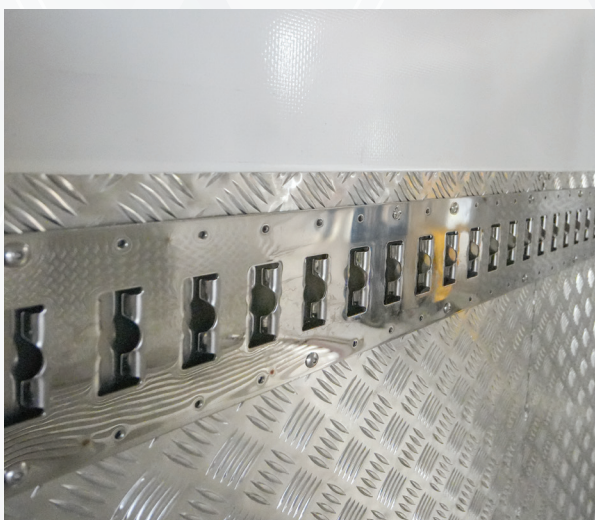

Cargo Track

Cargo Beam

An adjustable load bar used in trucks and trailers to secure cargo by spanning across the cargo space, preventing movement.



Cargo Beam

Cargo Belt

A strong strap used to secure loads in trucks, trailers, and containers, often with buckles or ratchets for tightening.

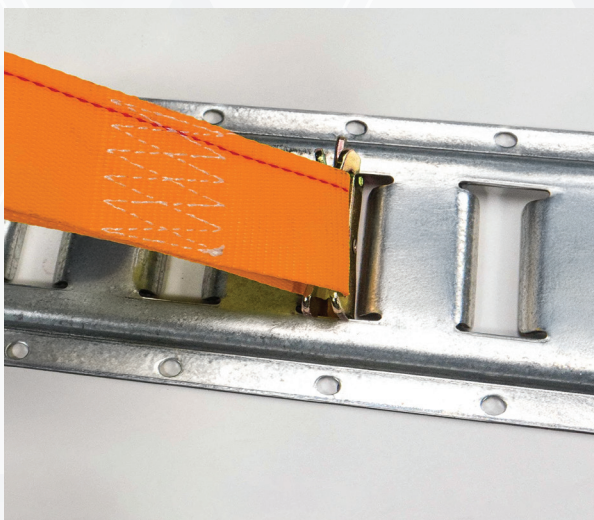

Cargo Belt

Antibac Curtain

This Antibacterial PVC Strip Curtains, stay protected and stylish with our high-quality antibacterial curtain, specially designed to promote a cleaner, healthier environment.



Antibac Curtain

Meat Hanger

A meat hanger ensures secure and hygienic meat storage, maintaining optimal temperature and freshness during transport.



Meat Hanger

Power Tail Lift

The power tail lifts are available in cantilever and undermount types, with cantilever models offering 1,000kg and 2,000kg payload capacities. Designed for efficient loading and unloading, they ensure reliable performance with hydraulic and electric control systems.



Cantilever Tail Lift



Undermount Bi-Fold, Retractable Tail Lift

Scan for more information:



Power Tail Lift
Catalogue



Power Tail Lift	Mechanism
<p>PTL 1000 Cantilever</p>	<p>It supports a payload of up to 1,000kg at CG600mm and powered by 4 cylinders, the lifting cylinder, door-close cylinder, frame support, lifting arm, motor, oil pump, hydraulic and electric control</p>
<p>PTL 2000 Cantilever</p>	<p>It supports a payload of up to 2,000kg at CG600mm and powered by 4 cylinders, the lifting cylinder, door-close cylinder, frame support, lifting arm, motor, oil pump, hydraulic and electric control</p>
<p>PTL 2000 UM Undermount Bi-fold, Retractable Tail Lift</p>	<ul style="list-style-type: none"> • The retractable under mount mechanism enables fast setup and secure storage, streamlining operations. • It supports a payload of up to 2,000kg at CG600mm and powered by four cylinders, with an arm length of 900mm.

Model



Cantilever



Undermount Bi-fold,
Retractable Tail Lift

EV Truck



Fully Electric Refrigeration Truck Solution

The 100% Electric Refrigerated Truck delivers sustainable and high-performance cooling for urban and regional transport. Powered entirely by electricity, it offers zero-emission operation with impressive efficiency.

Featuring a 10-year battery warranty and a driving range of up to 300 km, this vehicle ensures reliability and cost savings for long-term operations. Classified under Class 3 driving requirements, it combines advanced technology with ease of use for commercial drivers.

- Eco-friendly operation with no exhaust pollution
- Lower running costs compared to diesel trucks
- Reduced noise for urban and night-time delivery
- Fewer moving parts and simplified service needs
- Compatible with electric refrigeration units and telematics



EV Truck

Sustainability Insulated Container

The Sustainability Insulated Container combines advanced materials for superior cooling and long-lasting durability. Featuring Honeycomb Flooring that replaces marine plywood, it offers lightweight strength, moisture resistance, and eco-friendly performance. The Thermo Plastic Surfaces provide a smooth, hygienic, and recyclable finish for food-grade safety. Thermal Plastic Insulated Strips block thermal bridges to maintain consistent temperature and energy efficiency.



Insulated Container

Thermal Plastic Insulated Strip

Insulated Strips are designed to block thermal bridges, which are weak points where heat can easily pass through. By creating an effective barrier between interior and exterior surfaces, these strips help maintain stable internal temperatures and reduce energy loss.

By minimizing heat transfer between cold and warm zones, the strips help reduce cooling demand and maintain consistent temperature control throughout the container. This not only enhances energy efficiency but also ensures reliable performance for temperature-sensitive transport applications.



Insulated Strips

Eutectic Plate System (Ice Cream Container)

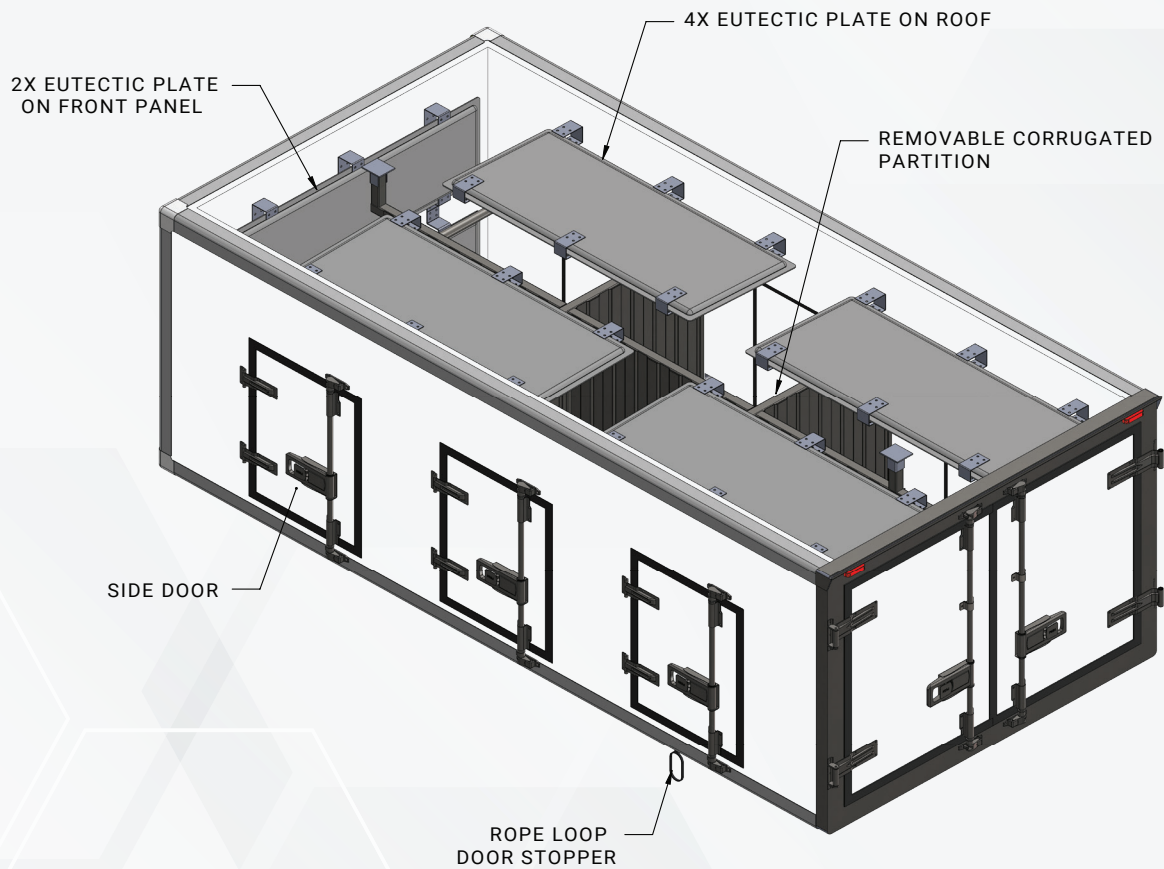

✓ Monzone Refrigerated Truck.
One-piece panels
More constant K Values
(Thermal Conductivity)

✓ More efficient compared
with traditional welding
technology, which can save
labor and time costs

✓ Quickly assembled with simple
tools such as screws, glue,
and screw guns

✓ Completion of the Monzone
refrigerated truck is anticipated
within approximately THREE
weeks

Eutectic Insulated Container



Eutectic plate system varies from 12ft to 18ft in our track record's construction

Multiple side doors are specifically designed for hand-reach loading and unloading process to control temperature retention.



Interior is compartmentalised by Eutectic plates and reinforced checkered plates for segmentation of products and better temperature management. You could also see our antibacterial curtains being introduced.

Scan for more information:



Video Ice Cream Container

MONZONE Track Record



Monzone specializes in the design and manufacturing of durable, high-quality insulated containers engineered specifically for the cold chain transport industry.

Our solutions are tailored to meet the unique requirements of diverse sectors and transportation needs, offering flexibility without compromising performance.

MONZONE Track Record

VEHICLE POWERED SV-SERIES & RV-SERIES



SELF-POWERED T-SERIES



TRAILER SYSTEM SLXi-SERIES



POWERED TAILGATE CANTILEVER & UNDERMOUNT BI-FOLD



CUSTOMIZED VAN INSULATION & PICKUP'S BODY DESIGN



With a comprehensive range of body configurations, we deliver outstanding reliability, operational efficiency, and consistent temperature control across various industries.

Trusted by a broad spectrum of clients—including government agencies—Monzone is a reliable partner committed to delivering precision and expertise for every project. Let us help bring your vision to life.

Customised Project & Tenders

2016: Rohde & Schwarz Asia Pte Ltd

Design and fabrication of a 16ft special-purpose van equipped with an antenna mast, including customised modifications to the fuel tank and the development of a tailored maintenance program to support this innovative project.



2017: NHGD, National Healthcare Group Diagnostic

Extensive fabrication utilizing antibacterial Glass Fiber Reinforced Panels to create a fully hygienic and sterile environment within the Mobile X-Ray van, ensuring optimal conditions for mobile radiography operations.



2017: HPB, 9m Mobile Dental Clinic Trailer

A groundbreaking initiative meticulously designed and built by Monzone's Engineering & Project Team, the first five-unit Mobile Dental Clinic (MDC) sets a new benchmark in mobile healthcare solutions. Each unit is thoughtfully equipped with essential features, including custom artwork decals, space-saving staircase designs, retractable awnings, antibacterial wall panels, hygienic table tops and cabinets, anti-slip flooring, exhaust ventilation, a system 3 air-conditioning unit, lead-lined X-ray rooms, and integrated water and electrical supply systems.



2017: SATS, Singapore Mobile Chiller Dolly

In 2017, Monzone's team designed and built Singapore's first Mobile Chiller Dolly—a pioneering solution in refrigerated ground handling. This innovative unit is equipped with the advanced TZ-1200 Thermo King refrigeration system and features a versatile internal storage design capable of accommodating LD3 and LD6 containers, as well as pallets. Customised stoppers are integrated to ensure safe and secure loading and unloading operations.



2017: SATS, Singapore Airport Terminal Services

Complete revamp of the scissor Hi-Lift body and structure, replacing it with a newly fabricated insulated container while retaining minimal existing components. The new build incorporates special treatment measures to effectively prevent termite intrusion, ensuring long-term durability and hygiene.



2020: HPB, Relaunch MDC

The newly designed artwork for the remaining seven units—part of the total 27-unit fleet—was created by the Health Promotion Board (HPB), with spray painting expertly executed by Monzone. The interior features a fully antibacterial design, including the flooring, tabletops, cabinet surfaces, and wall panels. This ensures a highly sterile environment, meeting the stringent hygiene standards required for the Mobile Dental Clinic (MDC) operations.



2020: dnata, Chiller Dolly

Design, fabrication, and construction of a specialized Mobile Chiller Dolly, including comprehensive operational testing for Quality Control and Quality Assurance, tailored for high-performance use in Coolport operations. Engineered for versatility, this unit is especially effective in transporting temperature-sensitive medical products and vaccines. It is equipped with a Thermo King SLXi-400 Flush self-powered refrigeration system, capable of maintaining temperatures as low as -25°C to ensure product integrity throughout the cold chain transportation



2022: NLB, Singapore National Library Board

Installation of new rooftop Thermo King CF-500 bus climate control units, along with major roof fabrication works on the Mobile Library minibuses. A comprehensive 3-year maintenance package was also provided to ensure long-term system performance and reliability. Leveraging our engineering expertise and extensive experience, we successfully resolved critical issues related to rainwater intrusion and air-conditioning performance—delivering significant cost savings to the customer.



2023: THERMO KING Fully Electric Refrigeration System

Monzone successfully completed the first installation of the Thermo King EV580 fully electric refrigeration system on a 10ft electric truck. The system demonstrated reliable, continuous operation at full load for six hours, powered by a battery capacity of approximately 54 kWh. This achievement represents a significant milestone in our commitment to advancing sustainable, fully electric refrigeration solutions.



2024: dnata, Hi-Lift Catering Truck Refurbishment Project

The Monzone team successfully completed a refurbishment project involving the construction of a new insulated body for a fleet of catering trucks. The scope of work included replacing the wire harness, repairing, and conducting comprehensive servicing of the refrigeration system. A selected fleet of Hi-Lift units was upgraded as part of this initiative, enhancing performance, reliability, and operational efficiency.



2025: NDCS, National Dental Centre SG, Mobile Dental Clinic

Monzone designed, developed, and fabricated a fully customized Mobile Dental Bus in strict compliance with the National Dental Centre Singapore (NDCS) specifications. The bus is equipped with a dental chair, an X-ray machine, antibacterial flooring, hygienic cabinets and tabletops, and custom-built wall panels—all tailored to ensure maximum surface hygiene and optimal operational functionality.



2025: SATS, A380 Hi-Lift Catering Truck Refurbishment Project

A series of Hi-Lift fleet vehicles – including the A380 Hi-Lift catering truck—are currently undergoing a comprehensive refurbishment program. The project scope includes the installation of a new insulated body, replacement of the wire harness, repainting, galvanizing, and the renewal of various key components. These upgrades are designed to extend the service life of the catering trucks while significantly enhancing their operational efficiency and reliability.



Machinery Overview



Laser Cutting Machine

This machine is used for high-quality laser cutting of metal plates, particularly excelling with thinner materials, where it delivers a more precise finish than conventional plasma cutters. It offers fast and efficient scanning and cutting capabilities, supporting straight lines in any direction and circular arcs arranged freely, with smooth, high-speed transitions. These features make it ideal for industrial sheet metal processing, structural steelwork, machinery fabrication, and shipbuilding components.



Metal Bending Machine

A press brake is a machine primarily used for bending sheet metal into various shapes and angles. It operates using a punch and die set, with different tooling options available to accommodate a wide range of bending applications. It can bend up to 10 meters in a single operation, making it suitable for handling large-scale components. Press brakes are widely utilized in industries such as automotive, construction, and manufacturing for producing components like brackets, panels, and enclosures.



Press vacuum table

The press vacuum table is used to apply layers to foam board panels for building insulated sandwich panels, mainly for refrigerated truck or lorry bodies. It handles foam cores like XPS or PU and outer skins like FRP, ensuring precise glue application for strong bonding. These panels provide crucial insulation to maintain temperature control, supporting the safe transport of perishable goods such as food, pharmaceuticals, and chemicals.



Magnetic lifter

The Magnetic lifter is built for handling large, flat, non-porous ferrous materials like metal sheets and panels. Using powerful magnets, it lifts and moves heavy items without suction or manual handling. Equipped with adjustable crossarms, magnetic pads, and parking stands for safety, it adapts to various sizes. Available in multiple capacities, the model shown handles up to 2000kg. Ideal for manufacturing, construction, and logistics where safe, efficient metal handling is crucial.



Hydraulic Shearing Machine

This hydraulic shearing machine is built for precise cutting of large metal sheets, featuring a powerful hydraulic system, touchscreen control panel, and robust steel frame for stability. Its integrated back gauge and clamping system ensure consistent, accurate cuts, while visible safety warnings and guard mechanisms protect the operator. Ideal for straight-line shearing in industries like construction, automotive, and manufacturing, it efficiently produces panels, blanks, and structural parts for fabrication or forming.



CNC Panel Cutting Machine (Router Type)

This heavy-duty CNC panel cutting machine is built for precise cutting of large-format materials like FRP/GRP boards, foam, and plywood. Featuring a robust gantry with an automated tool head and rail system, it delivers accurate multi-directional cuts. An integrated vacuum system secures materials and controls debris for safety and cleanliness. Ideal for cutting intricate or straight-line patterns, it ensures consistent, efficient results—perfect for truck panels, signage, insulation boards, and cladding components where precision and repeatability matter.



Laser Welding Machine

The welding machine is engineered for precise and reliable welding of metal components during the assembly of insulated panels and structural frames. It ensures strong, clean weld joints that maintain the structural integrity required for cold chain and transport applications. Designed with a focus on efficiency and operator safety, the system enhances production quality while supporting consistent and durable fabrication standards.



Glue Application Machine

The Glue Application Machine is designed for precise adhesive bonding of FRP/GRP panels, insulation foam, and metal sheets. Equipped with controlled roller or spray systems, it ensures uniform glue distribution for stronger, more reliable panel assembly. This system increases production efficiency, reduces material waste, and maintains consistent bonding quality, making it essential for cold chain manufacturing and panel production.

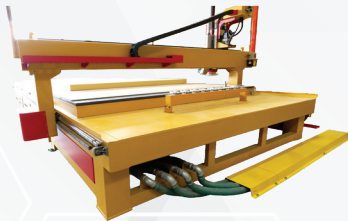

CNC Foam Cutting Machine

CNC foam cutting machines provide high precision in cutting complex shapes and designs from foam boards, ensuring accurate dimensions and clean edges. Controlled by computer numerical control (CNC) systems, they enable automated operation and efficient production, significantly reducing manual labor and minimizing errors. These machines are also highly versatile, capable of cutting various types of foam while accommodating different thicknesses and densities.



Decoiler Machine

These machines are designed for the continuous production of FRP/GRP panels, commonly used in truck bodies, refrigerated trucks, and other structural applications. They handle composite materials reinforced with fibers such as glass or carbon, ensuring optimal strength and durability through precise control. The resulting GRP panels are widely applied in industries like construction, transportation, and infrastructure due to their lightweight nature, high strength, water resistance, and excellent corrosion resistance.

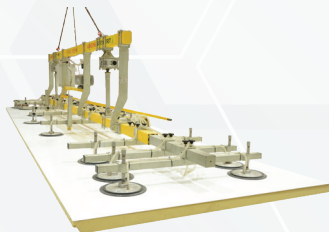

Vacuum Lifting System

This vacuum lifting beam system is designed for safely handling large, flat, non-porous materials like FRP/GRP panels, glass sheets, or metal plates. It features a sturdy frame with adjustable vacuum suction cups for even load distribution and is typically used with an overhead crane or hoist. Operated via manual or pneumatic controls, it ensures secure lifting without surface damage. A sucking machine technique protects materials during handling. Ideal for panel production, warehousing, and assembly lines in industries like construction, transportation, and manufacturing, it boosts efficiency while reducing risk of damage and injury.

MONZONE® Complete and Customised Solution for Your Transport Refrigeration needs

Monzone Singapore

Gul Lane
6 Gul Lane,
Singapore 629405
☎ +65-6365 1315

Woodlands

101 Woodlands Avenue 12,
#01-12 Polaris @ Woodlands,
Singapore 737719
☎ +65-8500 1315
☎ +65-6365 1315

Monzone Philippines

Philippines
7th Floor, Unit B, 8 Rockwell,
Hidalgo Drive, Poblacion, City of Makati,
Fourth District, NCR, Philippines, 1210
☎ +63-918 990 1315

Monzone Malaysia

Johor (HQ)
Lot 7015, Jalan Lagenda 1,
81000 Kulai, Johor, Malaysia
☎ +607-663 1315
Hotline: +6016-262 1315

Kedah

No. 16, Taman Jitra Jaya,
06000 Jitra, Kedah, Malaysia
☎ +604-917 2261
Hotline: +6016-262 1315

Sarawak

Lot 1993, Section 66,
Kuching Town Land District,
Jalan Semangat, Pending Industrial Estate,
93450 Kuching, Sarawak, Malaysia
☎ +6082-335 113
Hotline: +6016-262 1315

Shah Alam

No. 4, Jalan Sungai Pelubung
32/149, Seksyen 32,
40460 Shah Alam,
Selangor, Malaysia
☎ +603-5525 1153
Hotline: +6016-262 1315

Penang

No. 12, Lorong Iks Bukit Tengah,
Taman Iks Bukit Tengah,
14000 Bukit Mertajam
Pulau Pinang, Malaysia
☎ +604-507 2315
Hotline: +6016-262 1315

Sabah

Lot 27, Jalan Papar Lama,
Lok Kawi Industrial Estate, Phase 2B,
89600 Kota Kinabalu, Sabah, Malaysia
☎ +6088-201 315
Hotline: +6016-262 1315

For further information:

Email: monzone@singnet.com.sg

Website: www.monzonegroup.com

Monzone Customer Hotline

+65-6365 1315 (24/7)

+6016-262 1315 (24/7)

Visit & Follow Us



MONZONE
WEBSITE



MONZONE
FACEBOOK



MONZONE
INSTAGRAM



MONZONE
LINKEDIN



MONZONE
TIKTOK



MONZONE
YOUTUBE